



ActionCush II Plus™ Floor System

SYSTEM TYPE: FLOATING RESILIENT



Resilient laminated padded sleepers with 15/32" (12 mm) thick deck, APA exposure 1 rated sheathing, minimum APA span rating of 32/16

Action E-Cush 3/8" (10 mm) pad or 7/16" (11mm) AT II Natural Rubber pad



Option to specify Action Hardwood Premium Sheathing (HPS)

MFMA NORTHERN HARD MAPLE BY ACTION:

Random Length (RL)
Action Long Length (FJ)
Expansion Ridge Technology (ERT)

TESTING AGENCY:

Certified by ISSS

PERFORMANCE MEETS OR EXCEEDS:

FIBA, IHF, WSF

SLAB DEPRESSION:

25/32" (20 mm): 3-1/8" (79 mm)
33/32" (27 mm): 3-3/8" (86 mm)

LEED:



FloorScore®-certified
Proprietary certified EPD®
FSC®-certified Maple and Subfloor available
MR credits – based on products, selected materials and facility locations

PERFORMANCE & SYSTEM STABILITY:

- Floating resilient sleeper design
- Excellent ball bounce
- SCORES Compliant
- System features a high-profile height
- Cost effective system featuring laminated sleepers with continuous subfloor sheathing
- Contact Action for system variations to meet other slab or performance needs

- Delivers uniform surface, the floor system can be tuned to meet your performance expectations.
- Features the playability of laminated sleepers with a layer of APA rated 15/32" (12 mm) sheathing.
- The manufacturer and flooring shall be independently verified by the guidelines of the ISO 14040:2006 and ISO 14044:2006 Life Cycle Assessment (LSA) confirming a negative carbon footprint.
- Carbon Evaluation must be inclusive and based on all corporate facilities, offices and mills.
- The manufacturer and flooring shall be independently verified by the guidelines of the ISO 14064-1:2006 World Resources Institute Greenhouse Gas Protocol, Scope 1, 2 and 3.
- The manufacturer and flooring shall be registered in the Collaborative for High Performance Schools (CHPS) Product Database.
- Floor system manufacturer must provide a Life Cycle Assessment and an Environmental Product Declaration (EPD®) in accordance with the Product Category Rule Version 2.2014.
- Floor system manufacturer must be FloorScore® Certified in accordance with CDPH 01350.

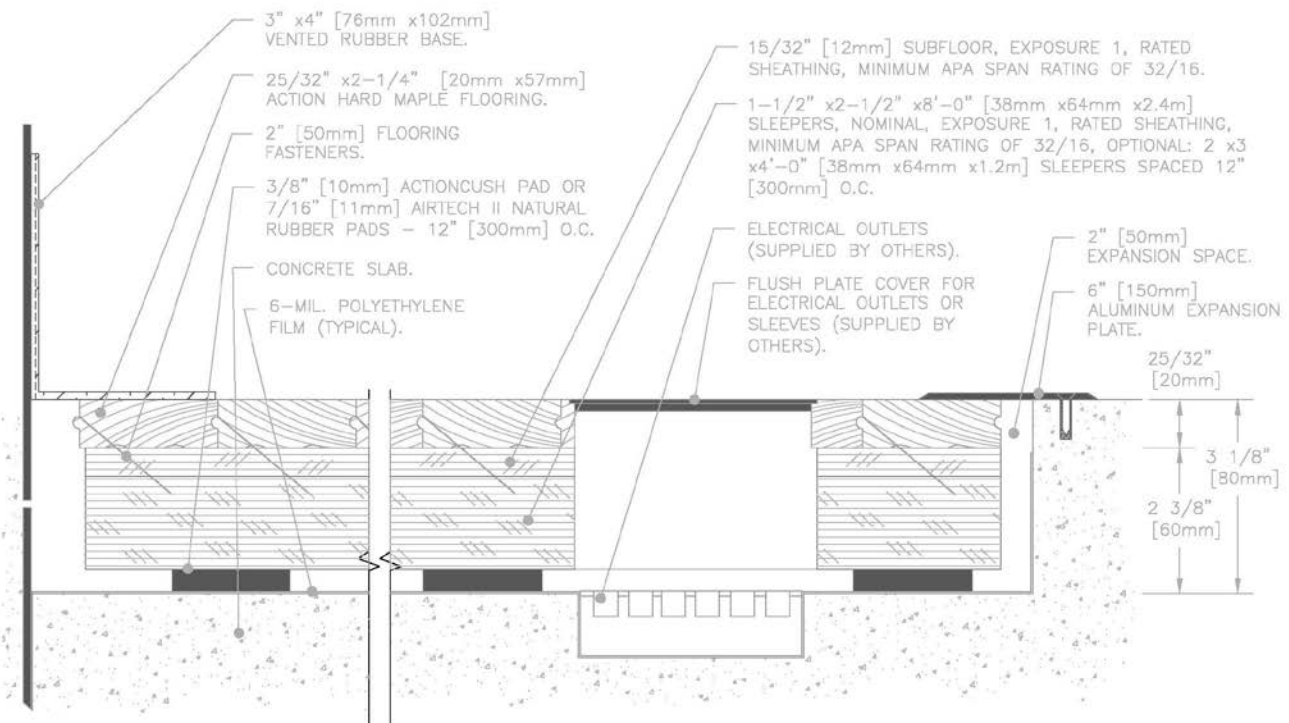

ActionCush_II_Plus
2014.12.28

Complete product specifications and system drawings are available online at: www.actionfloors.com



ACTION FLOOR SYSTEMS, LLC
4781 N. US Hwy 51 • Mercer, WI 54547
TOLL FREE: 800-746-3512 • VOICE: 715-476-3512
FAX: 715-476-3585 • EMAIL: info@actionfloors.com
actionfloors.com

Rev 12/17