

WALLBASE

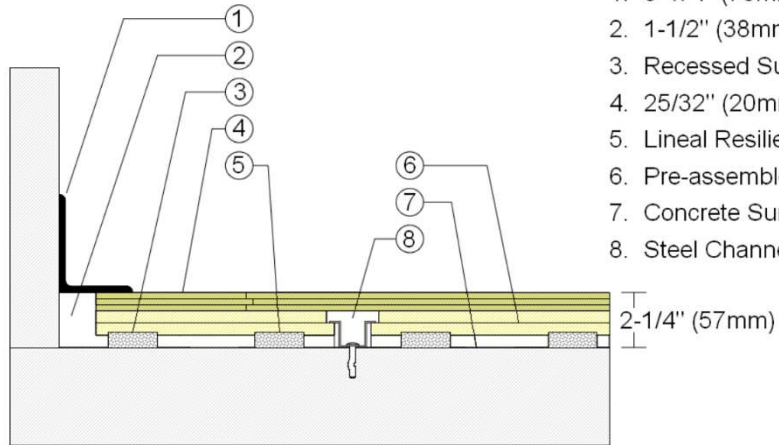

1. 3" x 4" (76mm x 101mm) Vent Cove Base
2. 1-1/2" (38mm) min. Expansion Space
3. Recessed Subfloor Groove
4. 25/32" (20mm) MFMA Maple Flooring
5. Lineal Resilient Cushion
6. Pre-assembled Subfloor Panel
7. Concrete Surface Vapor Retarder
8. Steel Channel and Concrete Anchor

THRESHOLD

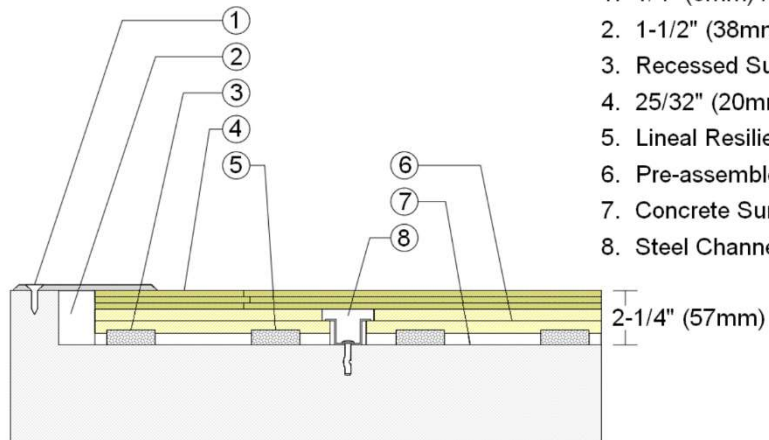

1. 1/4" (6mm) Aluminum Threshold
2. 1-1/2" (38mm) min. Expansion Space
3. Recessed Subfloor Groove
4. 25/32" (20mm) MFMA Maple Flooring
5. Lineal Resilient Cushion
6. Pre-assembled Subfloor Panel
7. Concrete Surface Vapor Retarder
8. Steel Channel and Concrete Anchor



Description: DW SLAM DUNK

Resilience: Lineal 3/4" OC Foam

Drawn By: RR

Date: 1/1/2025

Revisions

| ID | Description | By | Date |
|----|-------------|----|------|
| | | | |
| | | | |

EQUIPMENT

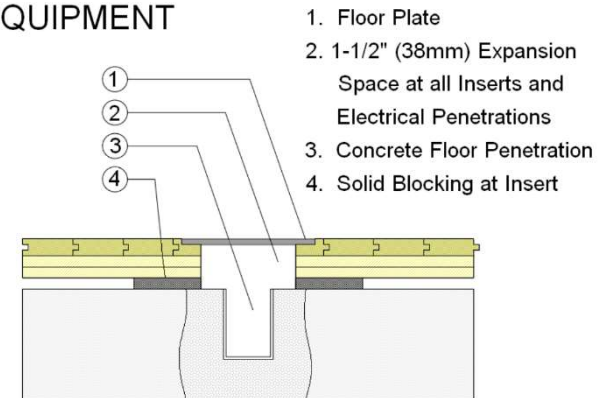

1. Floor Plate
2. 1-1/2" (38mm) Expansion Space at all Inserts and Electrical Penetrations
3. Concrete Floor Penetration
4. Solid Blocking at Insert